

# CRAFTED LIKE NO OTHER

## DON'T JUST SETTLE FOR THE SAME OLD BULL

**OWNER MANUAL**

NISSAN

Navara NP300 2015+



## WELCOME TO THE AFN FAMILY

This manual contains the Nissan Navara NP300 +2015 fitting instructions for:

Intercooler Skid Plate Ref.: 48002388

Gearbox Skid Plate Ref.: 48002315

Sump Guard Skid Plate Ref.: 48002314

Transferbox Skid Plate Ref.: 48002316



## 1 INTRODUCTION



### The Company

Founded in 1995, AFN - 4x4 Accessories dedicates itself to the production and commerce of all-terrain accessories. Its constant concern in its customers total satisfaction, and in the ideals of innovation and transformation have granted a position of notability both in the national and international panorama.

The only company in Portugal in the mass production of 4x4 accessories, relies on specialized and experienced technicians, with the most adequate knowledge, to an efficient response capability to its customers demands.

Thanks to the specialization in the several areas of design and manufacture and to a constant investment in technology, AFN has been broadening its wide range of products, without ever neglecting the quality factor.

### 4x4 Accessories

In its diversity of products we can include, with all-terrain quality, protection, safety and aesthetic accessories.

And it is here that AFN invest on the best technology, the best cut precision of the raw material, and the transformation of products with the quality recognized in the marketplace.

AFN has, at its disposal, resources to test and analyse the resistance of its products and stands in the front row regarding the European homologation of materials dedicated to all terrain.

The contact with the most important test laboratories for vehicles, both in England, Spain and Germany, provides AFN with the know-how to manufacture a wide range of quality products.

### Our Design Approach

AFN designs each accessory taking into consideration the original model lines and fitting points. We refuse to have a "one design fits all" solution and we are always looking forward to embrace new challenges on how to adjust a new product into a new model!

The days of just throwing on a bit of steel together to form a protection system are gone. AFN is leading the way modern vehicle protection components are manufactured. Other will follow, and it won't be long where the AFN approach to Styling, Fit, Form and Function will become the benchmark for all other manufacturers.







## INDEX

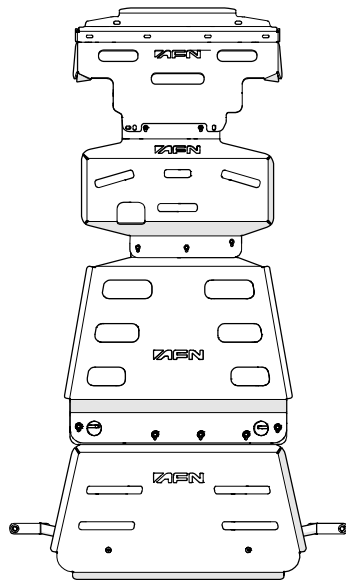

### AFN 4x4 Accessories

Product: **Intercooler Skid Plate**

Part Ref.: **48002388**

Product: **Sump Guard Skid Plate**

Part Ref.: **48002314**

Product: **Gearbox Skid Plate**

Part Ref.: **48002315**

Product: **Transferbox Skid Plate**

Part Ref.: **48002316**

**Introduction** 2

**1 Checklist** 4

Product 48002388

Product 48002314

Product 48002315

Product 48002316

**2 Fitting Instructions** 6

**3 NAVARA NP300 Catalogue** 16

**4 Warranty Terms** 17

**5 AFN 4x4 Partners** 18



# 1 CHECKLIST

- In this section you have a checklist with all parts included for the installation of your AFN product
- This product should be installed as demonstrated in the product fitting instructions
- If verified that any component is damaged, please contact your nearest AFN distributor
- The specified parts will only fit in the models specified by AFN
- Do not modify any component of the product

This checklists are for products **48002388\_48002314\_48002315\_48002316**.

48002388

NUMBER	DESCRIPTION	REFERENCE	QTY
1	Intercoolerr Skid Plate Nissan NP300	46007485	1x

48002314

NUMBER	DESCRIPTION	REFERENCE	QTY
2	Sump Guard Skid Plate Nissan NP300	46006621	1x
3	Shim <b>6mm Thickness</b>	46006622	1x
4	Bolt M6x40	45000190	5x
5	Washer M6	45000044	5x

48002315

NUMBER	DESCRIPTION	REFERENCE	QTY
6	Gearbox Skid Plate Nissan NP300	46006623	1x
7	Shim <b>6mm Thickness</b>	46006622	1x
8	Nut Plate M8	47001767	2x
9	Bolt M6x40	45000190	3x
10	Bolt M8x35	45000083	5x
11	Washer M6	45000044	3x
12	Washer M8	45000011	5x

48002316

NUMBER	DESCRIPTION	REFERENCE	QTY
13	Transferbox Skid Plate Nissan NP300	46006625	1x
14	Bracket Plate	46006629	2x
15	Nut Plate M8	47001767	2x
16	Transferbox Bracket	47001768	1x
17	Bolt M8x35	45000083	5x
18	Bolt M10x30	45000040	2x
19	Nylock Nut M10	45000017	6x
20	Washer M8	45000011	5x
21	Washer M10	45000010	10x
22	Bolt M10x30	45000007	4x

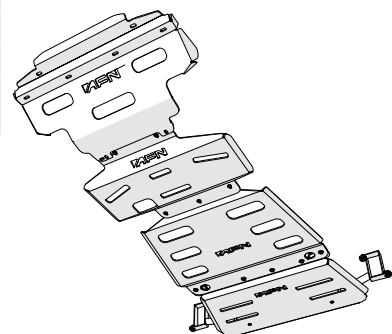

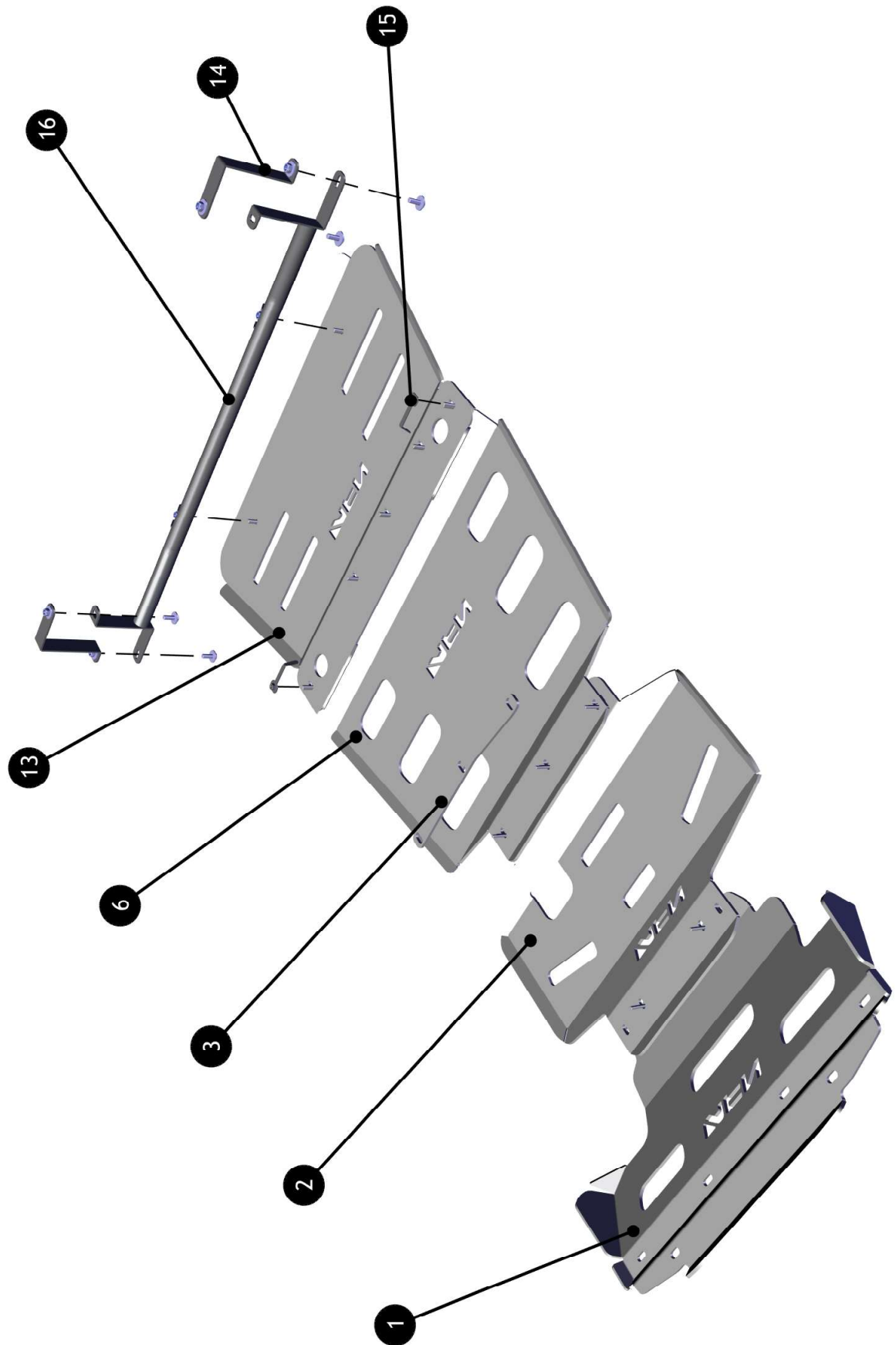



## 2 FITTING INSTRUCTIONS

### WARNING:

Before you begin installation, read all instructions thoroughly.  
Proper tools will improve the quality of installation and reduce the time required.

- This product should be installed as demonstrated in the *Product «Fitting Instructions»*;
- The specified parts, will only fit the models specified by **AFN**;
- Do not modify any component of the product;
- It is recommended that this product is installed by specialized and trained personnel;
- AFN doesn't take responsibility for changes made in the vehicle by its manufacturer;
- Work safely and use specialized tools at all times;
- Always use protective gear.



Size	Torque Nm	Torque lbft
M6	9 Nm	7 lbft
M8	22 Nm	16 lbft
M10	44 Nm	32 lbft
M12	77 Nm	57 lbft

### Mouting Time

- 2 hours (**All underbody protections**)
- 1 person (recommended)

### Tools Required

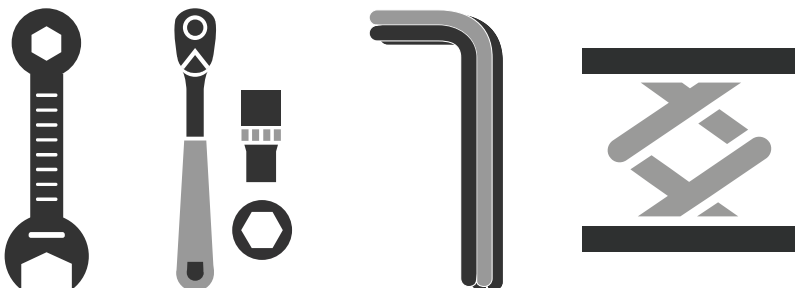

- Wrench
- Ratchet wrench
- Allen wrench
- Lift

## Step 1 - Place the Vehicle in a Lift

Start by placing the **Vehicle** in a **Lift**.

Lift the vehicle.  
(we do recommend to use a lift)



**Step 2 - Fitting Intercooler Skid Plate**

**Preview**

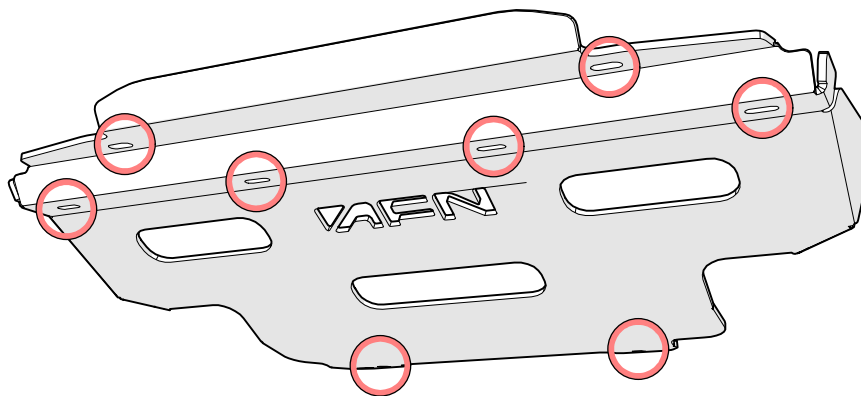

**Parts needed:**

**1**

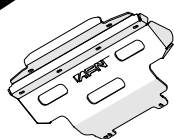

**x1** Intercooler Skid Plate  
Toyota Hilux Revo



**Step 2 - Fitting Intercooler Skid Plate****Installation**

Start by fitting removing the **OEM\*** Underbody Protection.

*(Be aware that you must save the OEM\* bolts and nuts.)*

**Give the final torque.**



Then, take on **Intercooleror Skid Plate(1)** and fit it in the **vehicle**.

Reuse the **OEM\*** bolts previously unscrewed.

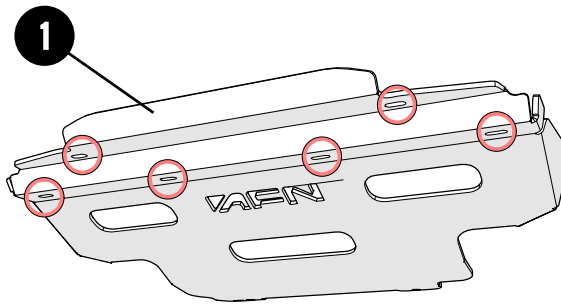

Just finger tight all bolts

**Do Not tighten yet**

**ATTENTION!**

Please note that if you have the **AFN Sump Skid Plate - 48002314** to be fitted, proceed to the next step.

On the back also reuse the **OEM\*** bolts previously unscrewed.

Just finger tight all bolts

**Do Not tighten yet.**

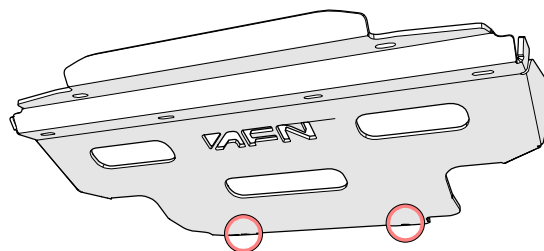

Once everything is correctly fitted,

**Give the final torque.**

\*OEM - Original Equipment Manufacturer

## Step 3 - Fitting Sump Guard Skid Plate

Preview

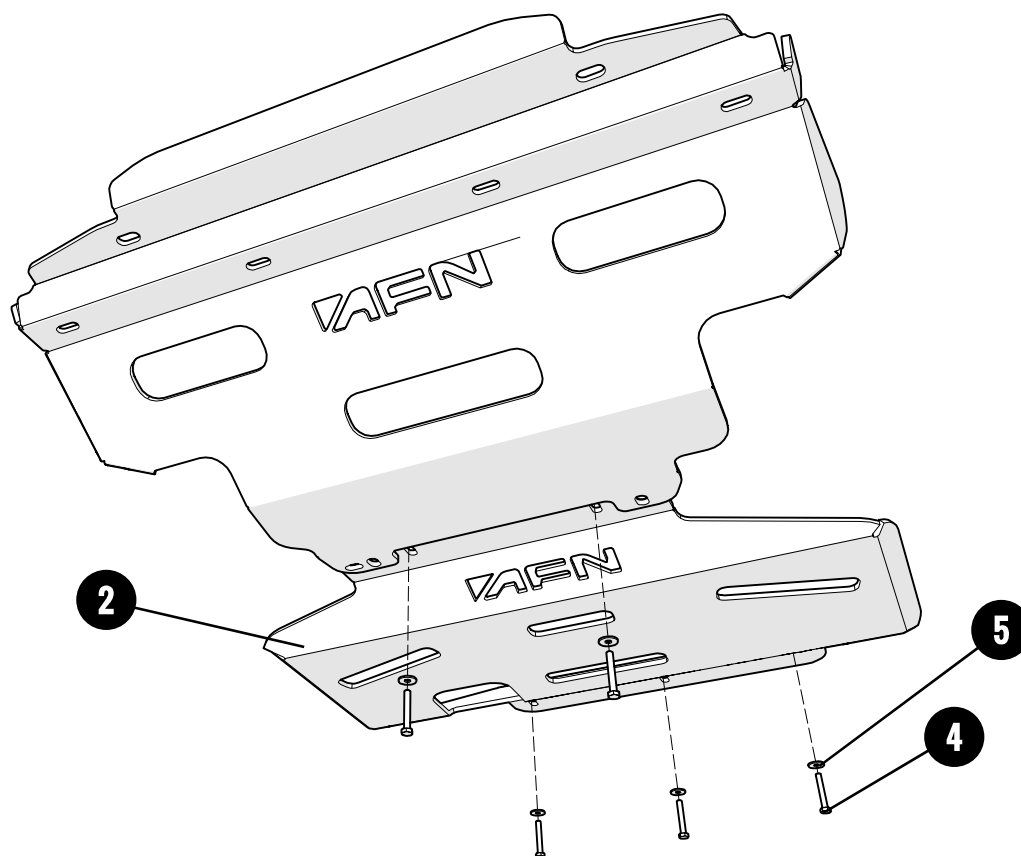

### Parts needed:

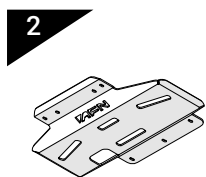

x1 Sump Guard Skid Plate  
Toyota Hilux Revo

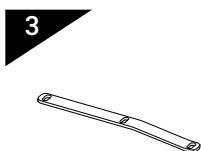

x1 Shim  
6mm Thickness

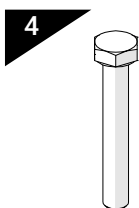

x5 Bolt **M6x40**

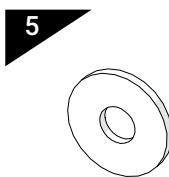

x5 Washer **M6**

### Parts left if fitting the AFN Gearbox:

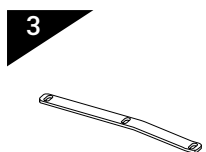

x1 Shim  
6mm Thickness

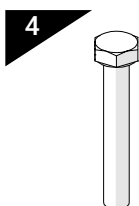

x3 Bolt **M6x40**

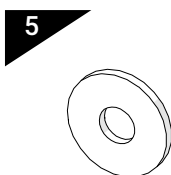

x3 Washer **M6**



**Step 3 - Fitting Sump Guard Skid Plate****Installation**

Take on **Sump Guard Skid Plate(2)** and fit it in the vehicle chassis.  
Bolts needed:

Use 2x Bolts M6x40(**4**) with 2x Washers M6(**5**).

Just finger tight all bolts

**Do Not tighten yet.**

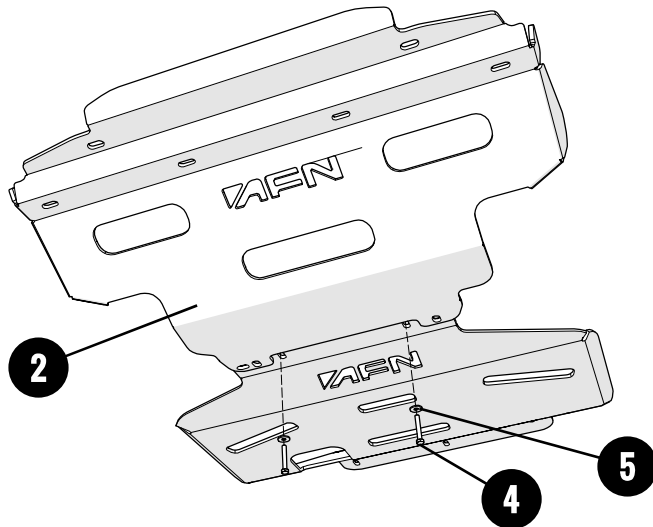
**ATTENTION!**

Please note that if you have the AFN Gearbox Skid Plate - 48002315 to be fitted, proceed to the next step.

Once that is done, fit the rear part of **Sump Guard Skid Plate(2)** also in the vehicle chassis. Bolts needed:

Use 3x Bolts M6x40(**4**) with 3x Washers M6(**5**) and 1x Shim(**3**).

Just finger tight all bolts

**Do Not tighten yet.**

Once everything is correctly fitted,

**Give the final torque.**

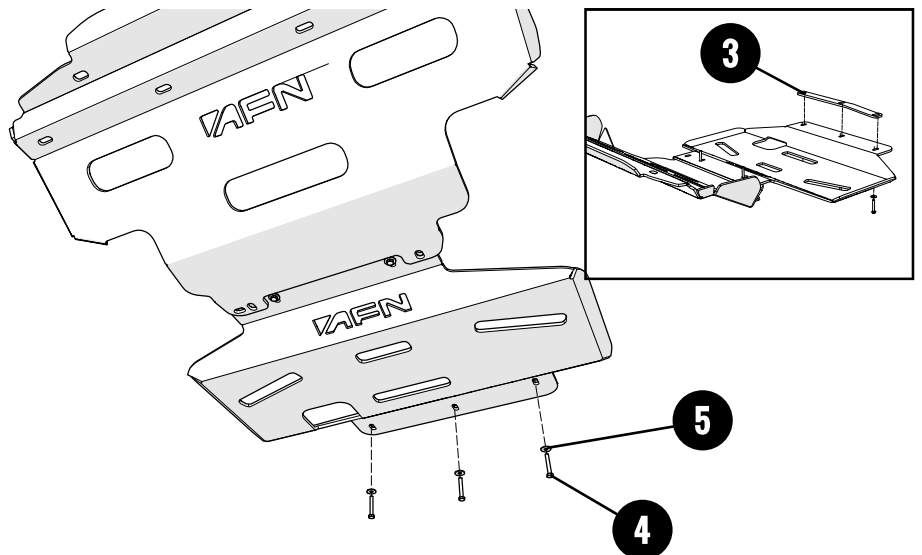

## Step 4 - Fitting Gearbox Skid Plate

Preview

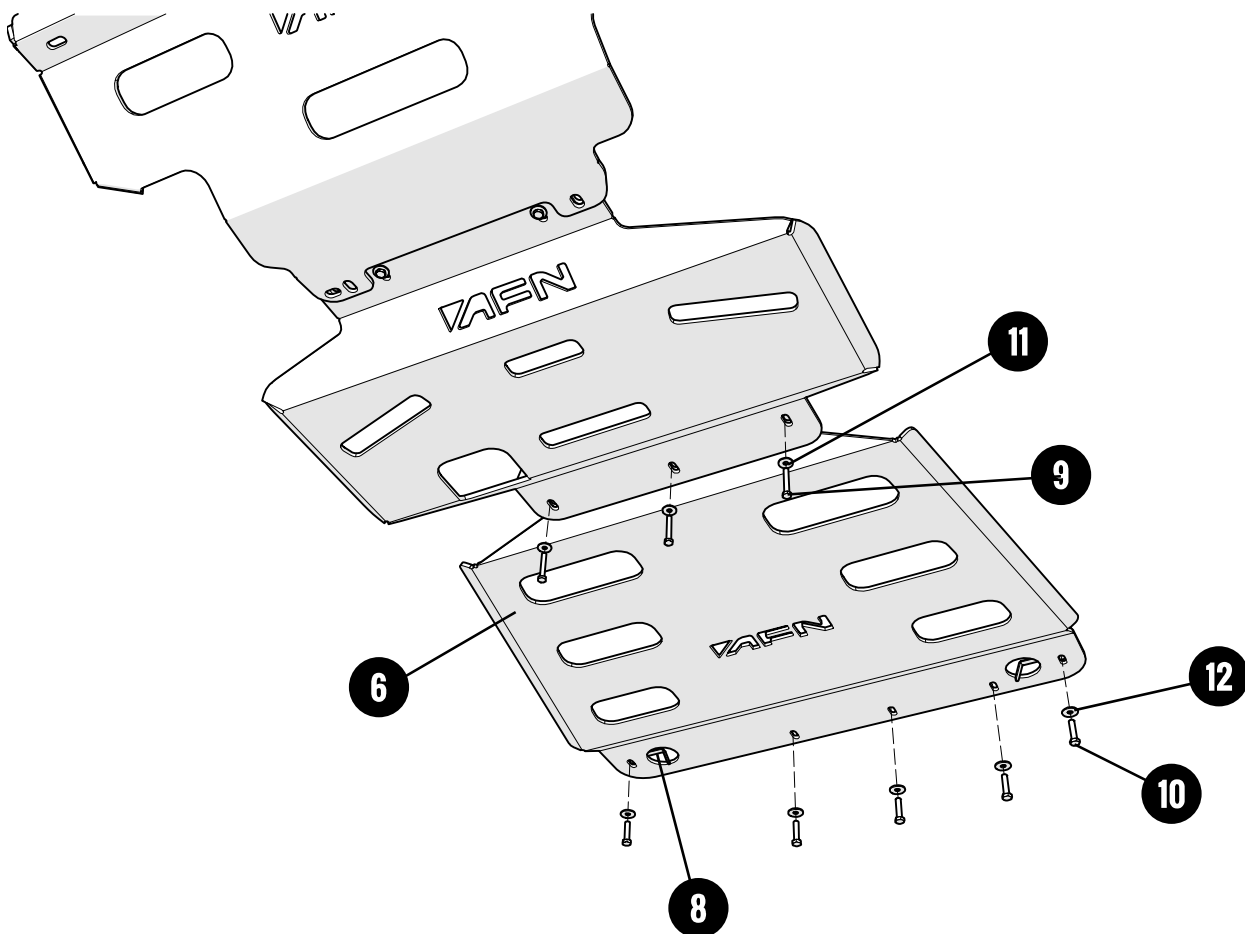

### Parts needed:

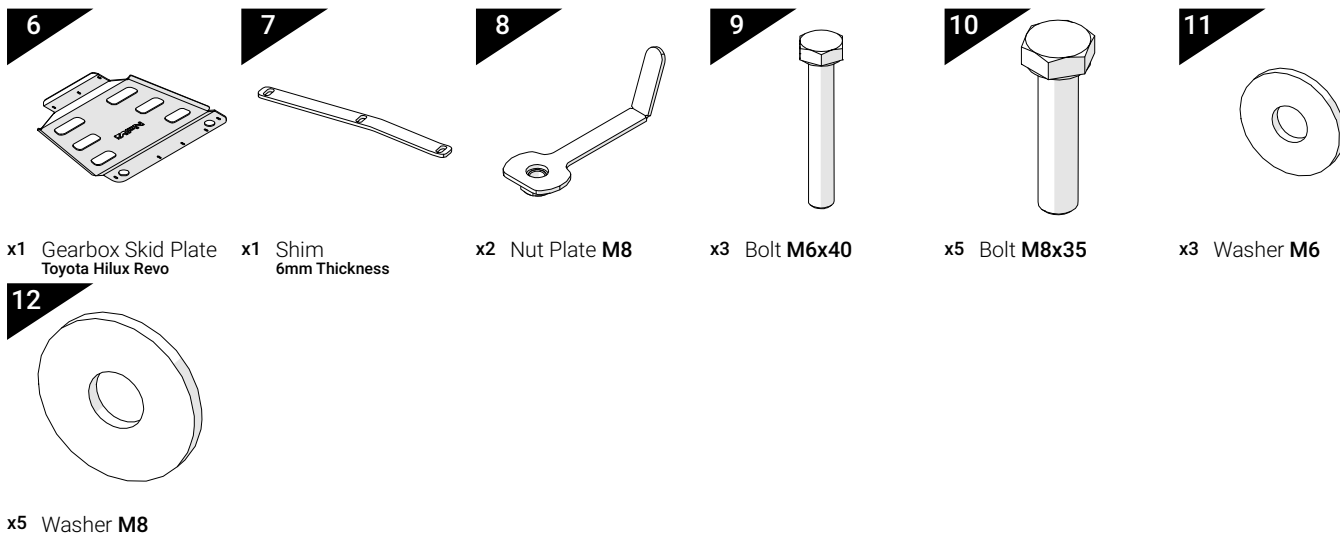

### Parts left if fitting the AFN Transferbox:

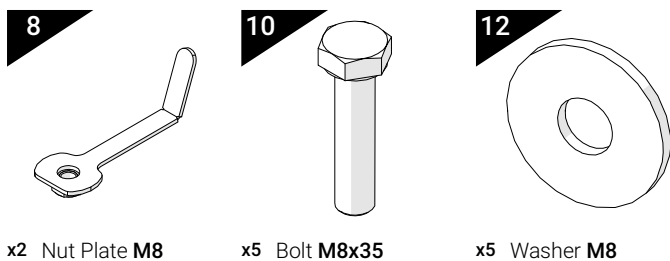



**Step 4 - Fitting Gearbox Skid Plate****Installation****ATTENTION!**

Please note that if you have the AFN Sump Skid Plate - 48002314 fitted, there are some bolts that will not be used, because they are the same.

Take on both Shim(7) and **Gearbox Skid Plate(6)** and fit them in the vehicle chassis. *(it must be fitted above the previous protection).* Bolts needed:

Use 3x Bolts M6x40(9) with 2x Washers M6(11).

Just finger tight all bolts

**Do Not tighten yet.**

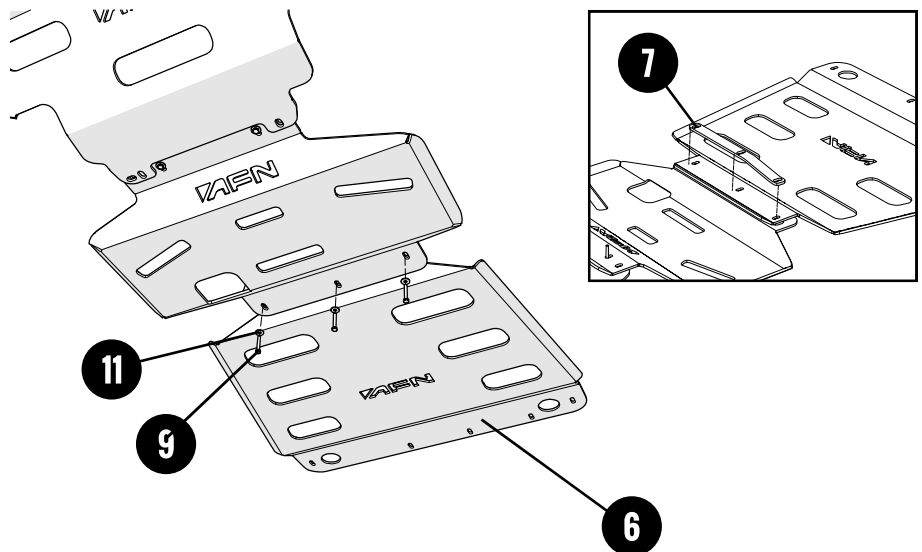
**ATTENTION!**

Please note that if you have the AFN Transferbox Skid Plate - 48002316 to be fitted, proceed to the next step.

Once the front of **Gearbox Skid Plate(6)** is secured, fit the back of it.

Use 2x Bolts M8x35(10), with 2x Washers M8(12) and 2x Plate Nut M8(8).

The arrows shows where each Plate Nut must enter in order to fix the GearboxSkid Plate into the vehicle.

Just finger tight all bolts

**Do Not tighten yet.**

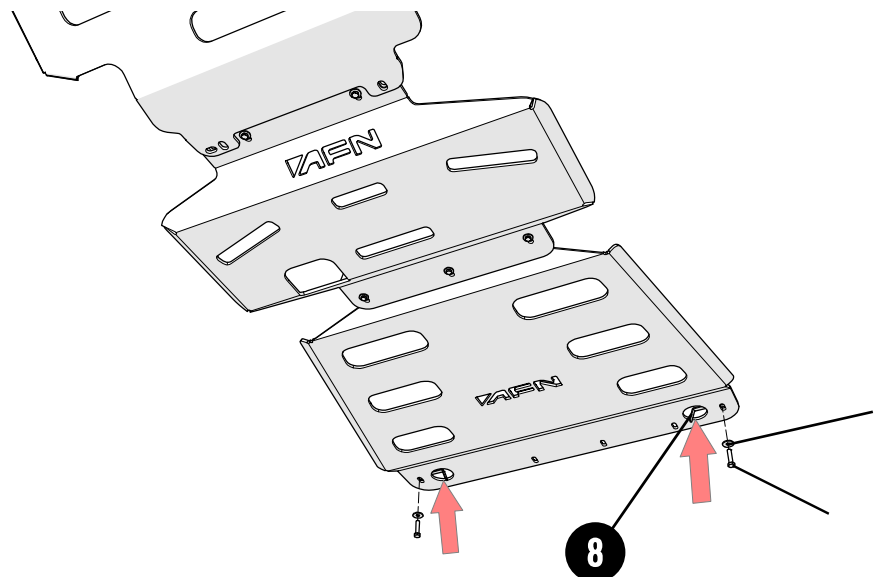

Finally, **fit** the back of **Gearbox Skid Plate(6)** in the vehicle. Bolts needed:

Use 3x Bolts M8x35(10), with 3x Washers M8(12).

Just finger tight all bolts

**Do Not tighten yet.**

Once everything is correctly fitted,  
**Give the final torque.**

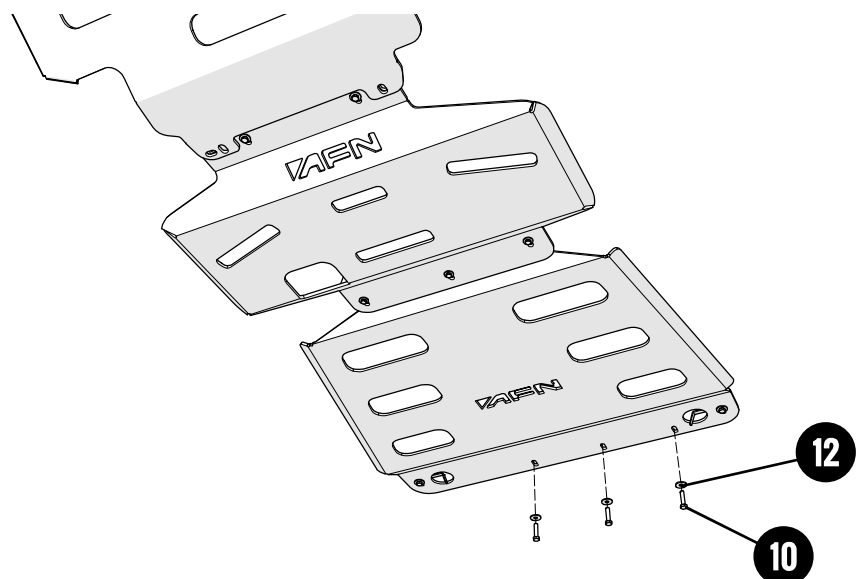

## Step 5 - Fitting Transferbox Skid Plate

Preview

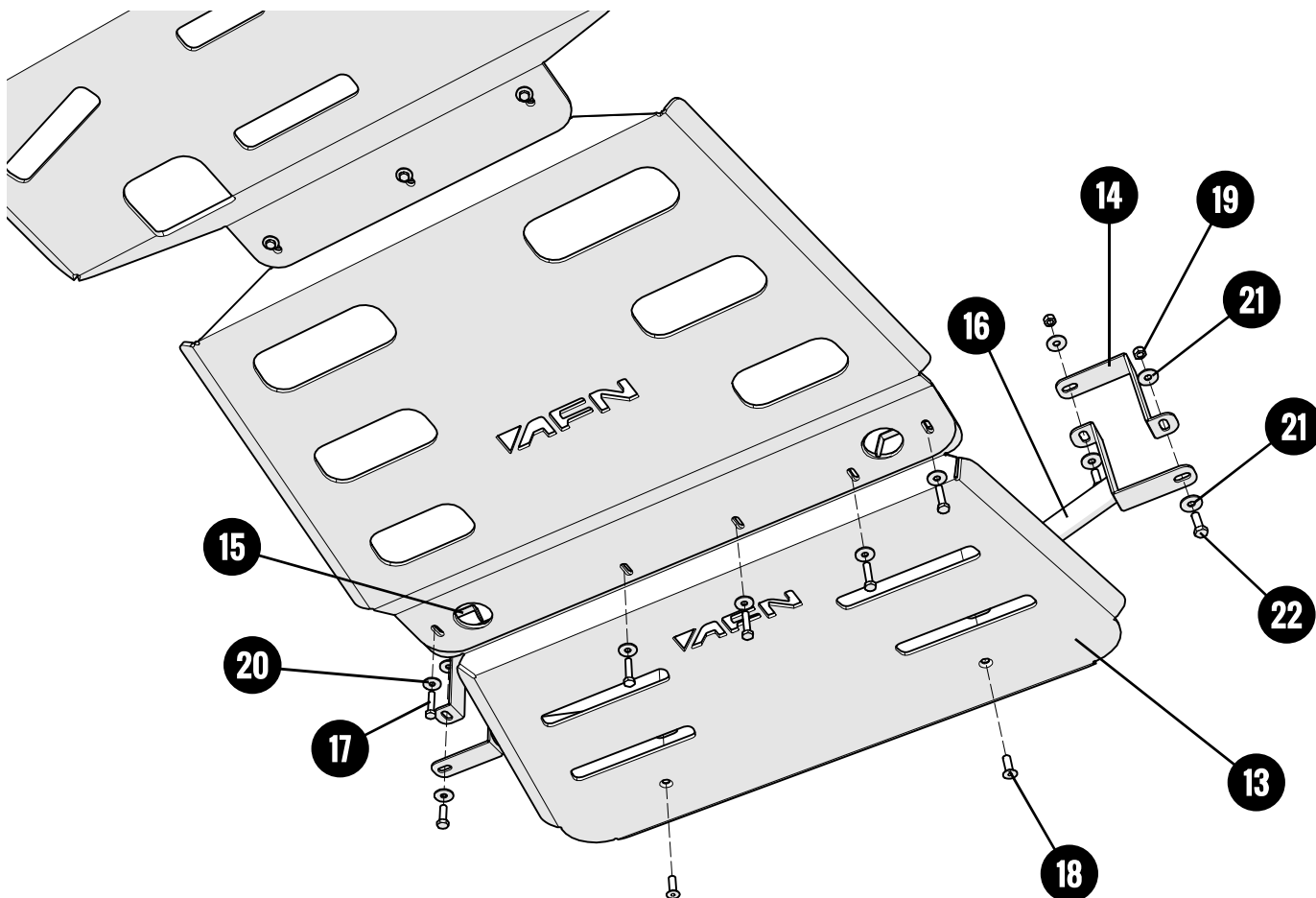

### Parts needed:

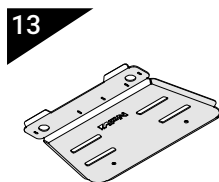

**x1** Transferbox Skid Plate  
Toyota Hilux Revo

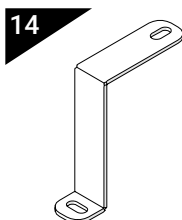

**x2** Bracket Plate

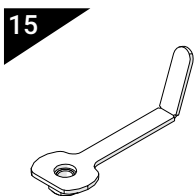

**x2** Nut Plate M8

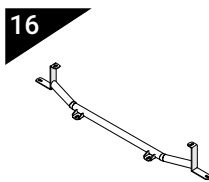

**x1** Transferbox Bracket  
Toyota Hilux Revo

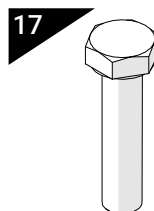

**x5** Bolt M8x25

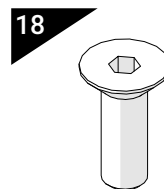

**x2** Bolt M10x30

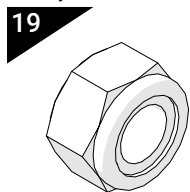

**x6** Nylock Nut M10

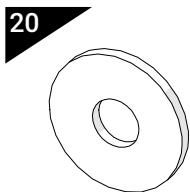

**x5** Washer M8

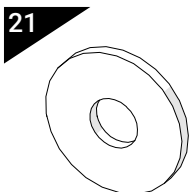

**x10** Washer M10

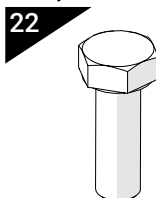

**x4** Bolt M10x30



**Step 5 - Fitting Transferbox Skid Plate****Installation**

Start by fitting the **Transferbox Bracket(16)** into the **Transferbox Skid Plate(13)**. Bolts needed:

Use 2x Bolts M10x30(**18**) and 2x Washers M10(**21**) with 2x Nylock Nuts M10(**20**).

**Give the final torque.**

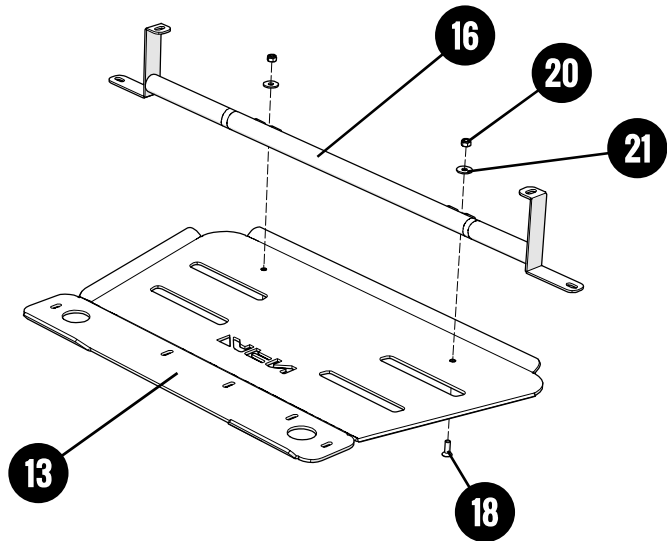

Then, take on that assembled part and fit it on the vehicle. **(it must be fitted above the previous protection)**. Bolts needed:

Use 5x Bolts M8x25(**18**), with 8x Washers M8(**20**) and 2x Nut Plates M8(**19**).

Just finger tight all bolts

**Do Not tighten yet.**

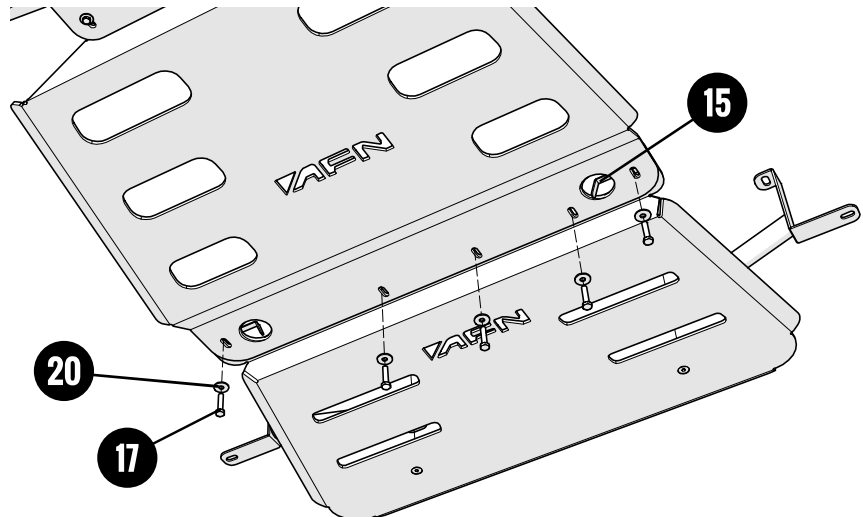

Finally, fit the bottom of **Transferbox Skid Plate(13)** on the vehicle using both Bracket Plates(**14**). Bolts needed:

Use 4x Bolts M10x30(**22**), with 8x Washers M10(**21**) and 4x Nylock Nuts M10(**19**).

Just finger tight all bolts

**Do Not tighten yet.**

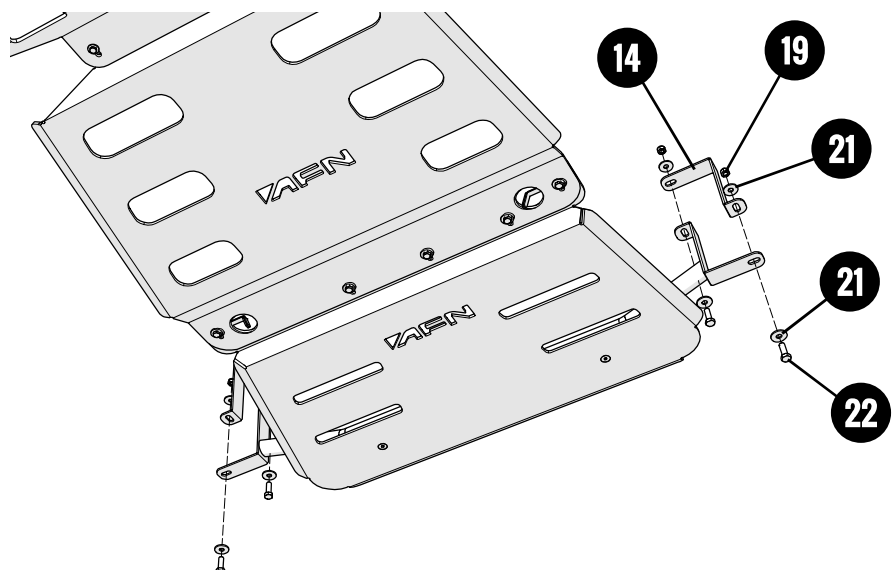

Once everything is correctly fitted,

**Give the final torque.**

## Step 5 - Final Result

## Preview



Your new **AFN UNDERBODY PROTECTIONS** are now installed on your **Nissan NAVARA NP300!**

Have Fun!

### Reminder !

Before operating a vehicle fitted with an AFN Underbody Protections:

- Make sure all fittings are tightened

### Maintenance | Care

Periodically check and tighten all nuts. Stripped, fractured or bent bolts or nuts need to be replaced.

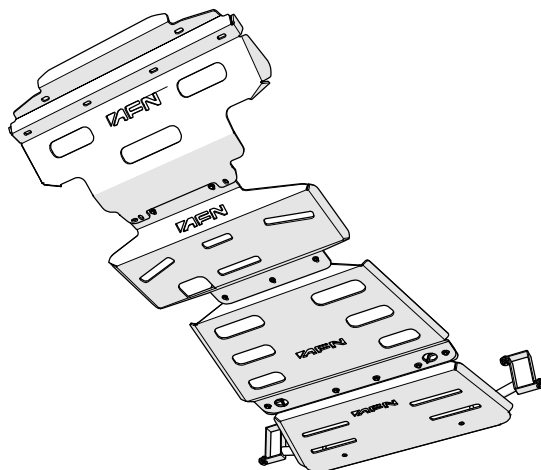





## 3 NAVARA NP300 CATALOGUE

**AFN 4x4 Accessories** is becoming a well known brand for its products due to its quality, design and safety which are challenged for thousands of people everyday, worldwide.

In its diversity of products we can include, with all-terrain quality, protection, safety and aesthetic accessories. With that being said, **AFN 4x4** has some other accessories that every offroad passionate would like to have, such as **Body Protections, Underbody Protections, Light Holders, Storage** (Wheel Supports and Jerry-can carriers) and others related to the **Aesthetics**.

We have some 4x4 accessories that combine with the original model lines that if you take a closer look you will see that they don't appear to be an accessory, but a must-have.

Please be in mind that some accessories are available only to some models.

Feel free to check all the products that may interest you in our website at: [www.afn.pt](http://www.afn.pt)



Ref.: 48002320 - Bull Bar with fog lights



Ref.: 48002319 - Front Bumper



Ref.: 48002381 - Side Steps



Ref.: 48002382 - Nerf Bars



Ref.: 48002311 - Rear Step Bar w/ trailer hitch



Ref.: 48002310 - Rear Bumper w/ Wheel and Jerry-can carrier



Ref.: 48002314 - Sump Skid Plate (\*Al)



Ref.: 48002315 - Gearbox Skid Plate (\*Al)



Ref.: 48002316 - Transfer Box Skid Plate (\*Al)

## 4 WARRANTY TERMS

**AFN4x4** products are warranted free from defects in materials and workmanship for a period of two (2) years from the date of initial retail purchase. Third-party components are delivered under the original manufacturer warranty.

Under the present warranty, **AFN4x4** obligation shall be limited to repairing, replacing or crediting, at its option, any part found to be defective.

**AFN4x4** does not warrant or make any representations concerning its goods when:

- a) The products are purchased used, scratch and dent or when the box was opened.
- b) The products are not installed, used, and maintained strictly in accordance with **AFN4x4**'s instructions.
- c) The products are installed in vehicles that are used in competition.
- d) The products are installed in vehicles fitted with aftermarket non-standard tires with diameters in excess of OEM\* specifications.
- e) The products are installed in vehicles with engines that have been modified to increase performance.

**AFN4x4** will not be responsible for goods damaged in transit. If any goods arrive damaged, please contact the **AFN4x4** as soon as possible. **AFN4x4** will assess and may arrange to have the damaged goods returned to a **AFN4x4** Distributor and arrange for a replacement of the goods. Damaged goods must be returned in the condition received by you with all original packaging, accessories and/or manuals. If they are not returned in same condition sent there may be an additional fee charged.

To file a claim under this warranty please contact **AFN4x4** at +351 256 808 300 or via email at [geral@afn.pt](mailto:geral@afn.pt) to request a *Returned Goods Authorization (RGA)* number and instructions for returning the defective component.

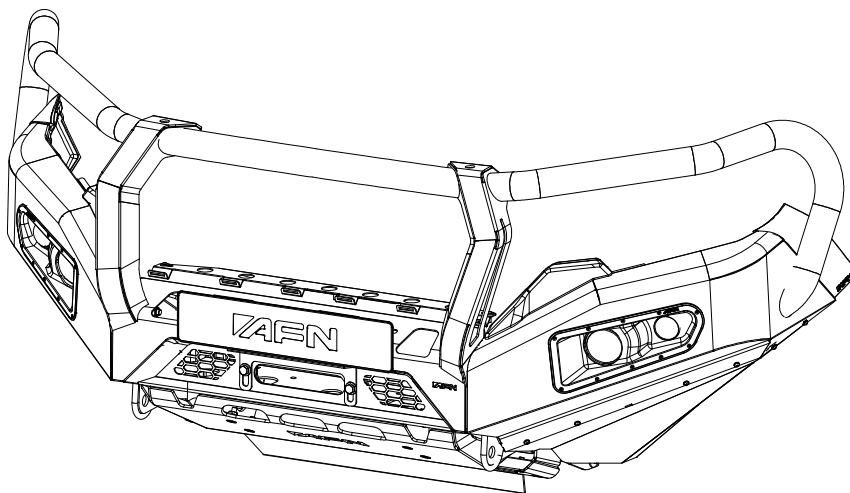





## 5 AFN 4x4 PARTNERS

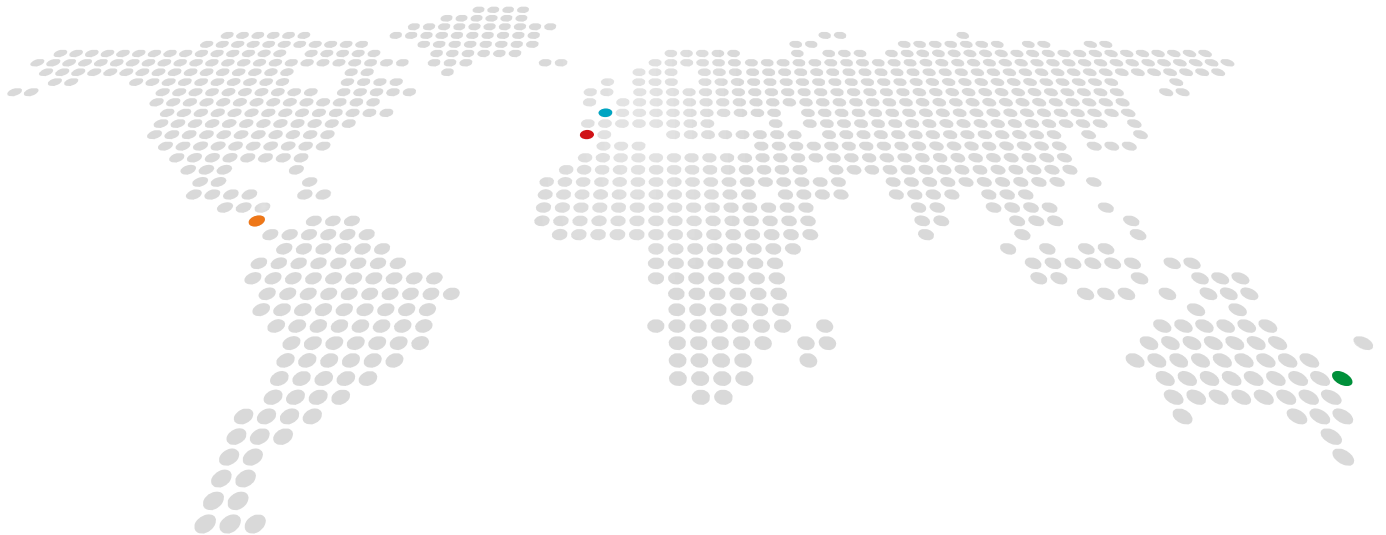

**01**

### Portugal

Rua da Madeira, 113  
Z. Industrial das Travessas  
3700-176 S. João da Madeira

T:(00351) 256 838 300/7  
geral@afn.com  
www.afn.com

**02**

### Espanha

Carretera de Moledo 8  
pol. ind. de Miraflores, Nave 20  
36214, Vigo (Pontevedra)

T:(0034) 986 378338  
info@4x4misutonida.com  
www.4x4misutonida.com

**03**

### Austrália

19 Flinders Parade  
North lakes  
QLD 4509

T:(0061) 1300 236 494  
sales@afn4x4.com.au  
www.afn4x4.com.au

**04**

### Costa Rica

Fort overlanding CR,  
Alajuela

T:(0011) 506 8430 0211  
info@fortoverlanding.com  
www.fortoverlanding.com



DON'T JUST SETTLE FOR THE SAME OLD BULL



WWW.AFN.PT | SALES@AFN.PT | FACEBOOK.COM/AFN4X4

# WELCOME TO THE AFN COMMUNITY



União Europeia

Fundo Europeu de  
Desenvolvimento Regional

